

SprinKit

SPRINKLER IRRIGATION SYSTEM

10,000 m²

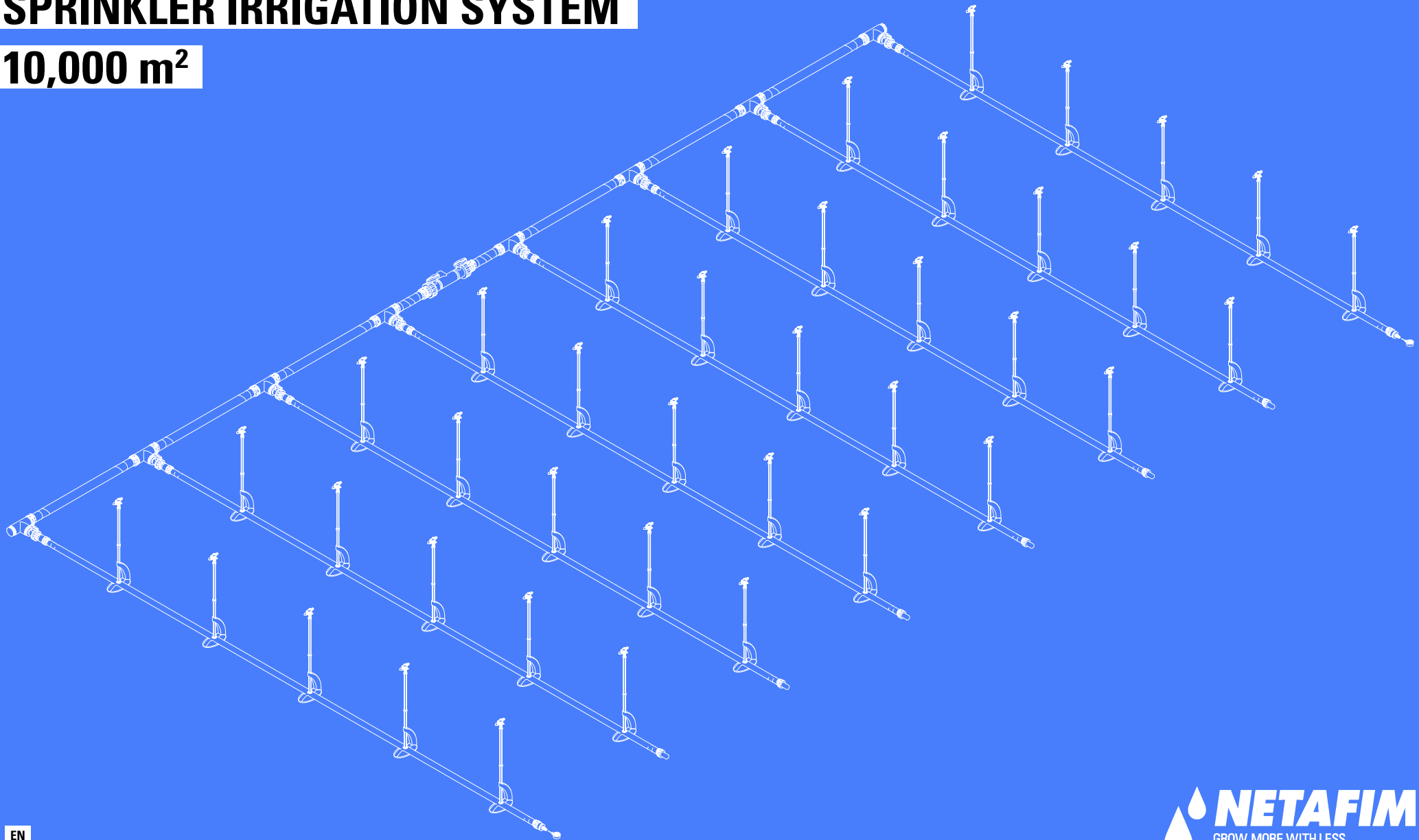

SprinKit Models

#	Product	Cat. number	CU @ 2.5 bar
A	SprinKit, MegaNet, IMP SPR stand, PE, 10*10m	42000-027200	92.0%
B	SprinKit, D-Net, IMP SPR stand, PE, 13*10m	42000-013120	90.2%
C	SprinKit, D-Net, MegaStand, FlexNet, 13*10m	42000-013110	90.2%
D	SprinKit, MegaNet, IMP SPR, FlexNet, 10*10m	42000-013000	92.0%

Required inlet pressure and filtration

Inlet pressure

Filtration

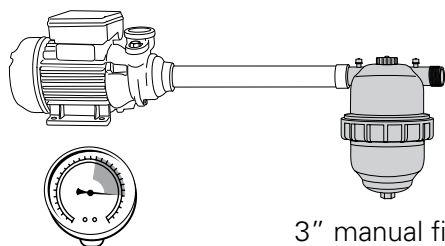

2.5 bar

3" manual filter

PRV - Optional

Order if needed, not supplied with the SprinKit package

Product	Cat number
PRV 2000 3" BSP 3.0 bar 43 PSI 10U	30580-001700

Parts for piping repairs

Order if needed, not supplied with the SprinKit package

Product	Cat number
FXN coupling 2"*2" kit	43040-018000
Plasson coupling 32*32	75040-008200
PE irrigation pipe 32/4 S, 100m	40500-006430
FXN HP 3" blank pipe, 50m	43000-000550
FXN HP 2" with 1/2" connector/10.0m, 50m	43000-007320
NetaFix NFP puncture fix kit box	42000-007000

List of components

#	Part Description	System Model/Qty.			
		A	B	C	D
A	PVC 90 deg threaded T 3"	11	9	9	11
B	NMV PVC ball valve 1 union 3" FMT BSP	2	2	2	2
C	FXN MTH BSP 3"*3" kit	20	18	18	22
Distr. line	D FXN HP 3" blank 100m	1	1	1	1
	E PVC threaded plug 3"	2	2	2	2
	F Plastic bushing 3"*1½"	10	8		
	Plastic bushing 3"*2"			8	10
	G NMV PVC ball valve 1 union 1½" FMT BSP	10	8		
	FXN ball valve 2" kit			8	10
	H Male adaptor 32*1½"	10	8		
Lateral	I PE irrigation pipe 32/4 S 100m*	10	8		
	FXN HP 2", 100m w/ ½" connectors 10.0m			8	10
Line end	J Line end 32mm	10	8		
	FXN line end cap 2" kit			8	10
Sprinkler	K MegaNet 24D ½IC 350l/h head only	100			100
	D-Net 8550 580l/h 2.5+1.8		80	80	
Tool	L Punch 8 mm plastic w/adaptor inserter	1	1		
Stand	M IMP SPR stand 9*12 120cm	100	80		100
	N Metal rod 8mm 120cm length	100	80		100
	O Mega Base			80	
	P Mega Supporting Arm			80	
	Q Mega Riser 0.4m			160	
Check Point	R Female adaptor 32*¾"	2	2		
	FXN MTH BSP 2"*2" kit			2	2
	S Plastic female reducer 2*¾"			2	2
	T Pipe bushing ¼F*¾M	2	2		
	Pipe bushing ½F*¾M			2	2
	U Check point kit straight ¼"*¼" MTH	2	2		
	Check point kit straight ¼"*½" MTH			2	2
	V NPG pitot needle ¼" BSP	1	1	1	1
	W NPG 2.5" GLC 0-4 bar ¼" BSP	1	1	1	1
Teflon tape	X Narrow Teflon tape	20	20	20	20

*The PE irrigation pipe 32/4 S 100m is not supplied with the SprinKit systems A and B. Order the required quantity for your SprinKit system from a local supplier.

Components

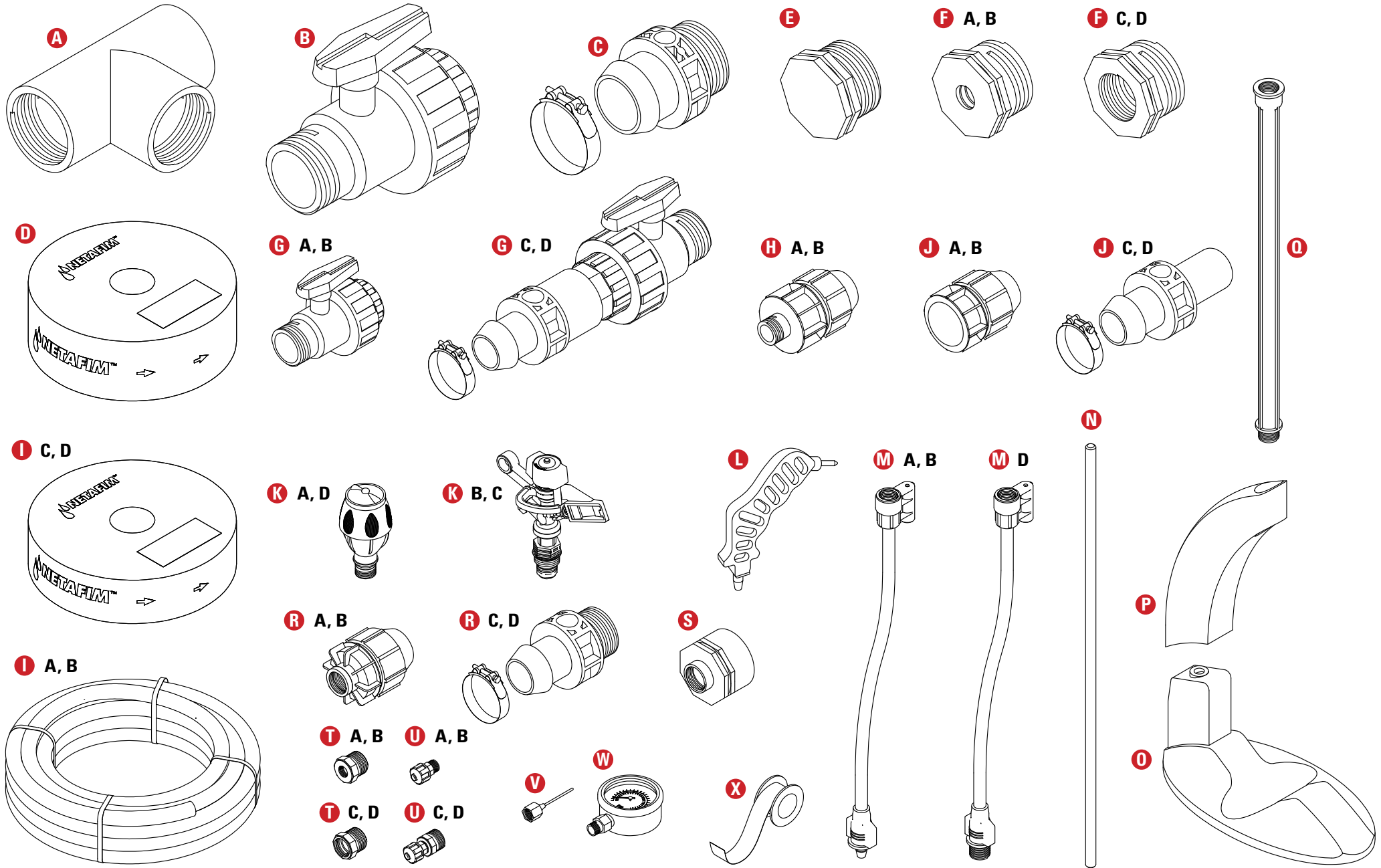

System Layouts

Systems A and D

Sprinkler quantity: 100

Lateral quantity: 10

Total area: 10,000 m²

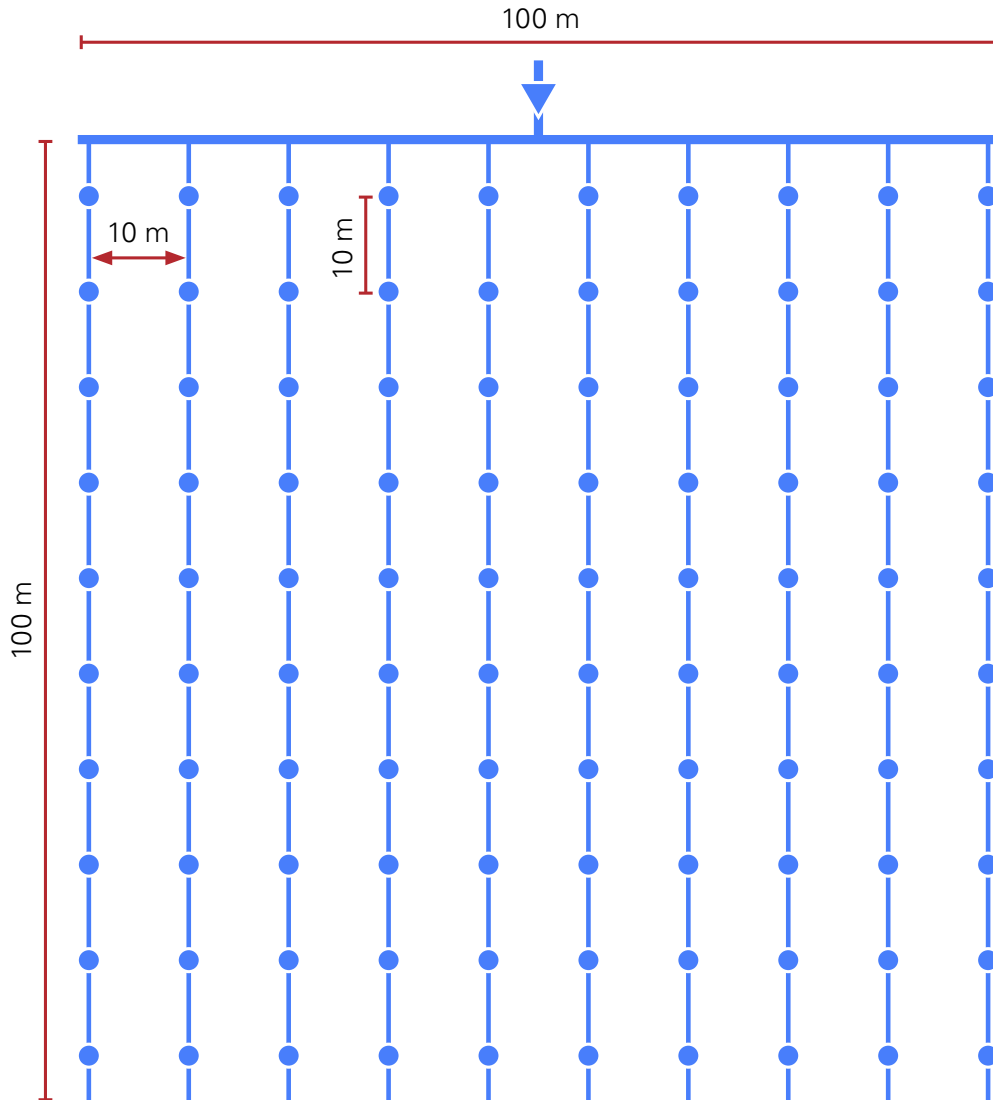

Systems B and C

Sprinkler quantity: 80

Lateral quantity: 8

Total area: 10,000 m²

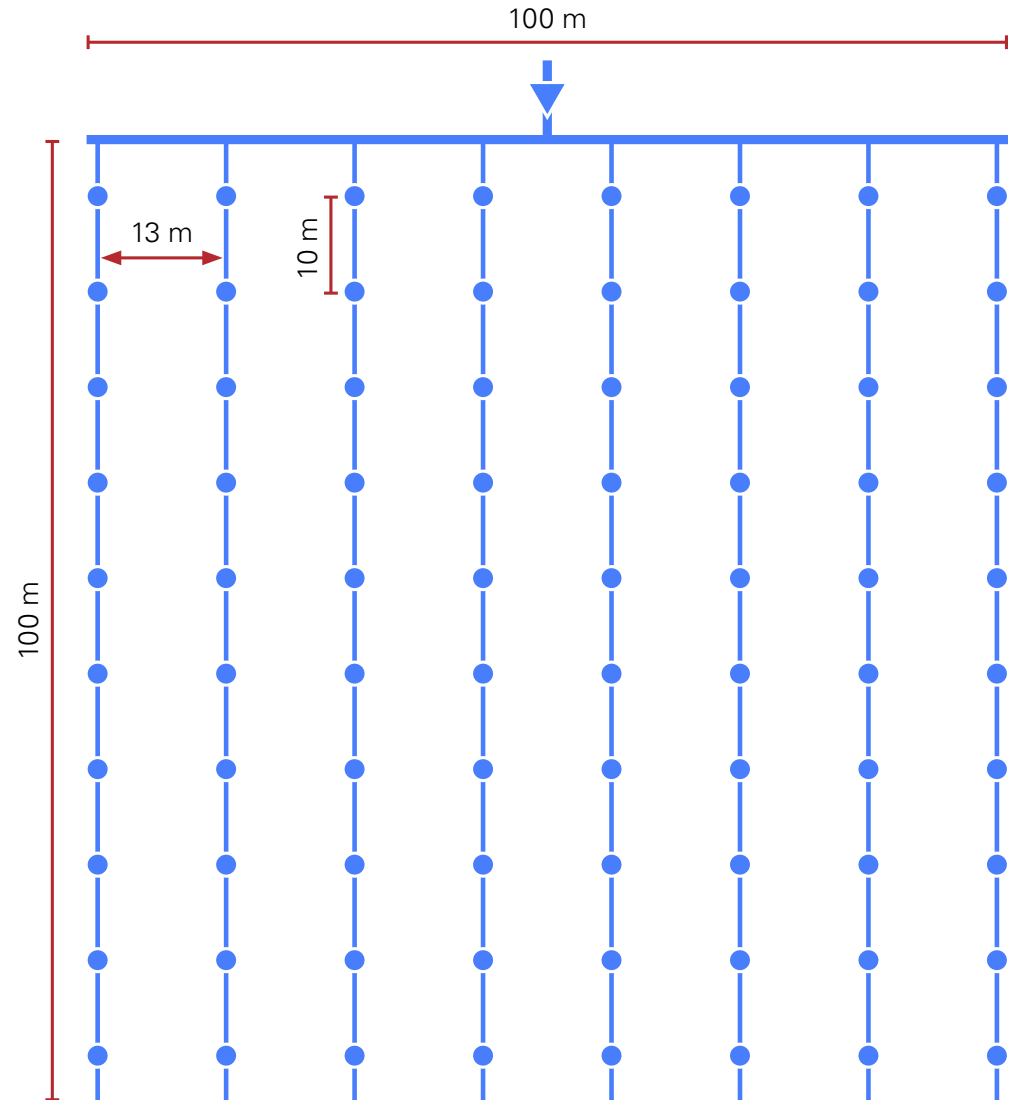

Assembly



NOTE

Apply 15 windings of narrow Teflon tape **X** to each male thread.

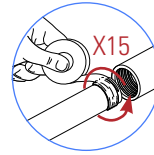

1 Systems A and D

Cut 8 sections of 10m length and 2 sections of 5m length of FXN HP 3" blank pipe 100m **D**.

Systems B and C

Cut 6 sections of 13m length and 2 sections of 6.5m length of FXN HP 3" blank pipe 100m **D**.

2 Distribution line assembly

Perform assembly steps **1**, **2** and **3** according to the system installed.

3 Lateral assembly

Perform assembly steps **4** and **5** according to the system installed.



NOTE

Systems **A** and **B**: Punch equidistant holes every 10 m along each lateral PE pipe, with the supplied punching tool **L** before proceeding to assembly step **6**.
(See the IMP SPR Stand Installation Manual included in the DripK package).

4 Stand and sprinkler assembly

Perform assembly step **6** described in the corresponding Stand Installation Manual included in the DripK package according to the system installed.

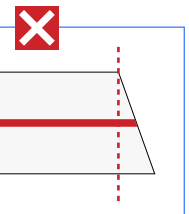
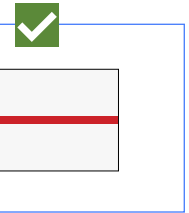
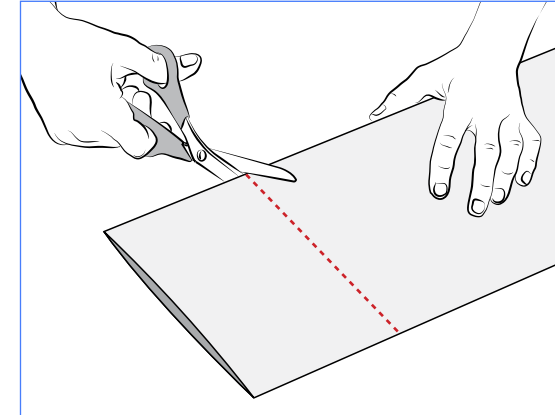

Portable pressure gauge

A portable pressure gauge with a pitot needle is supplied in each SprinKit package.

Each SprinKit system far-left and far-right lateral end-of-lines are fitted with a convenient pressure check point.

To measure the system pressure thrust the portable pressure gauge needle into the pressure check point.

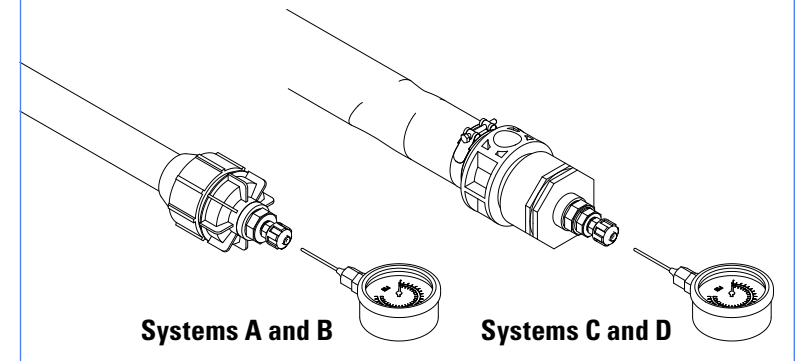

SprinKit System A

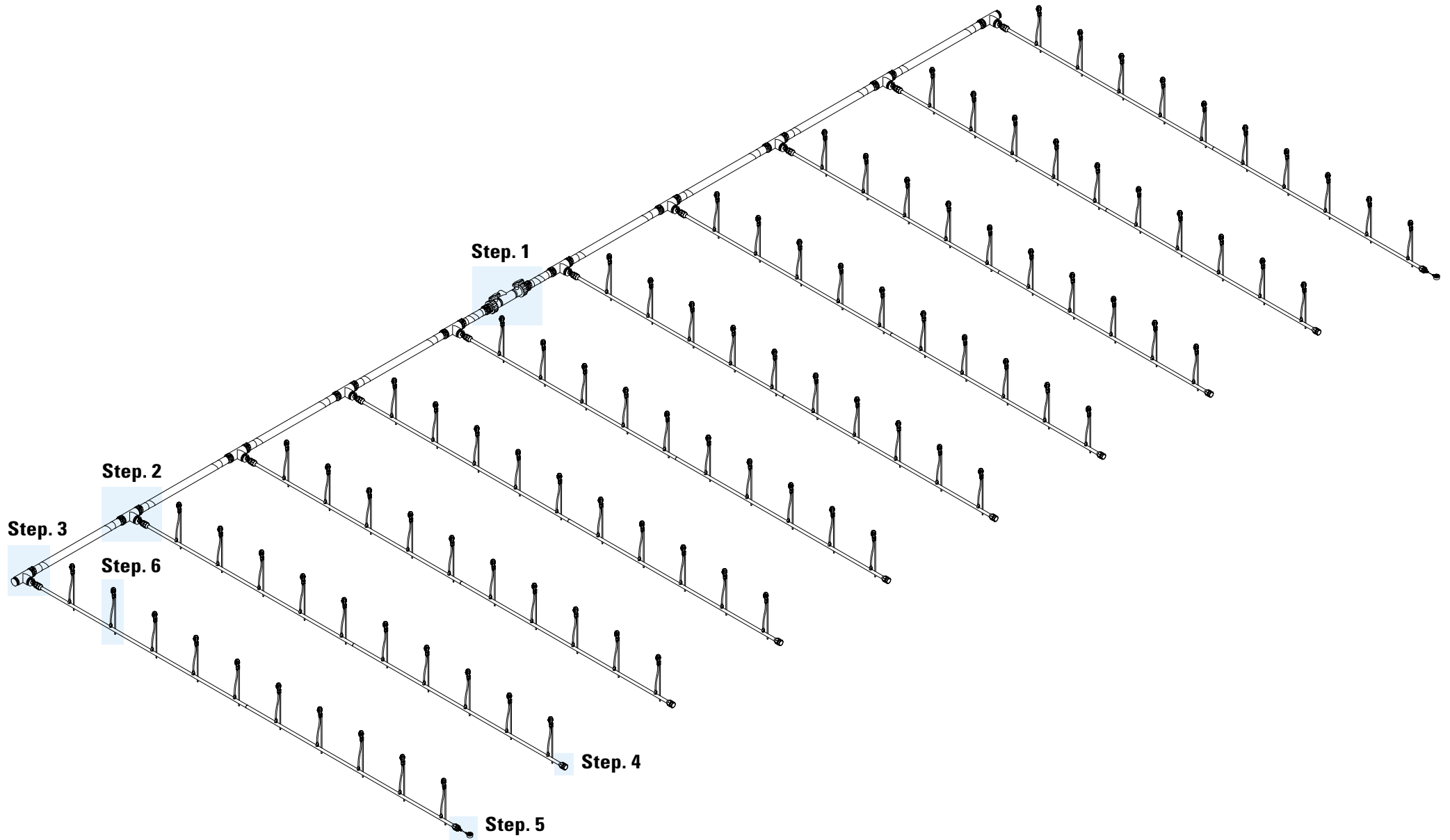

SprinKit System B

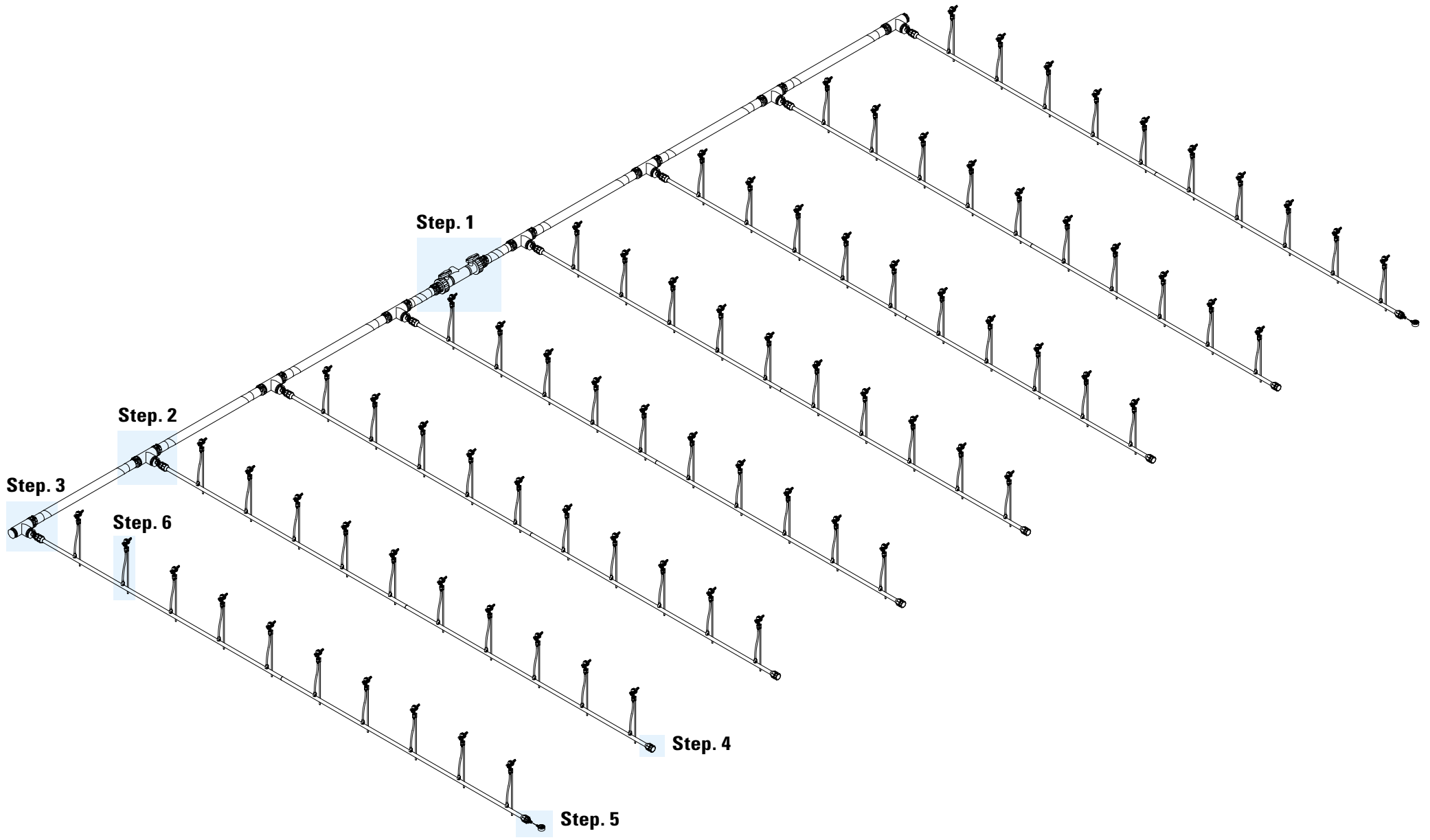

SprinKit System C

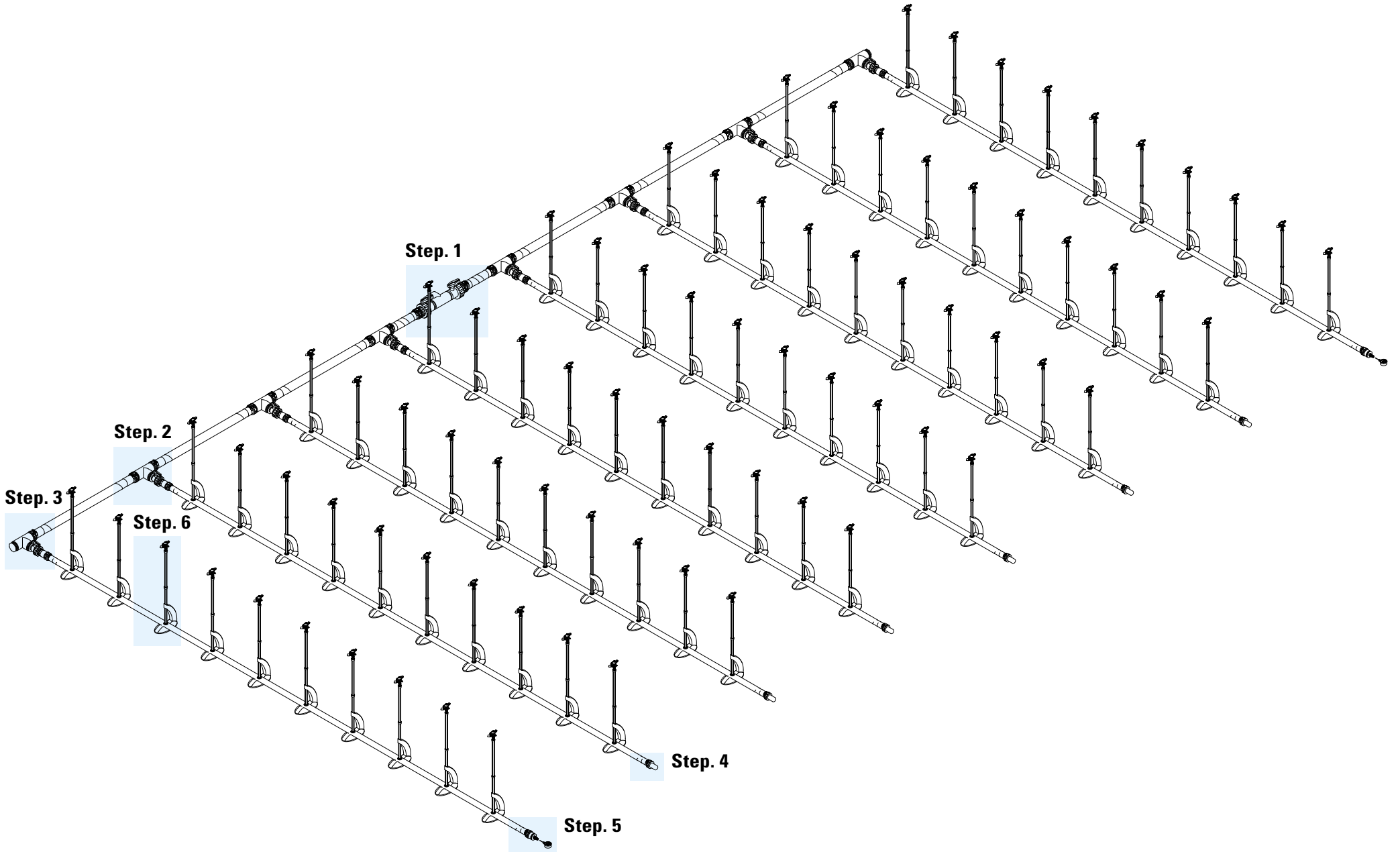

SprinKit System D

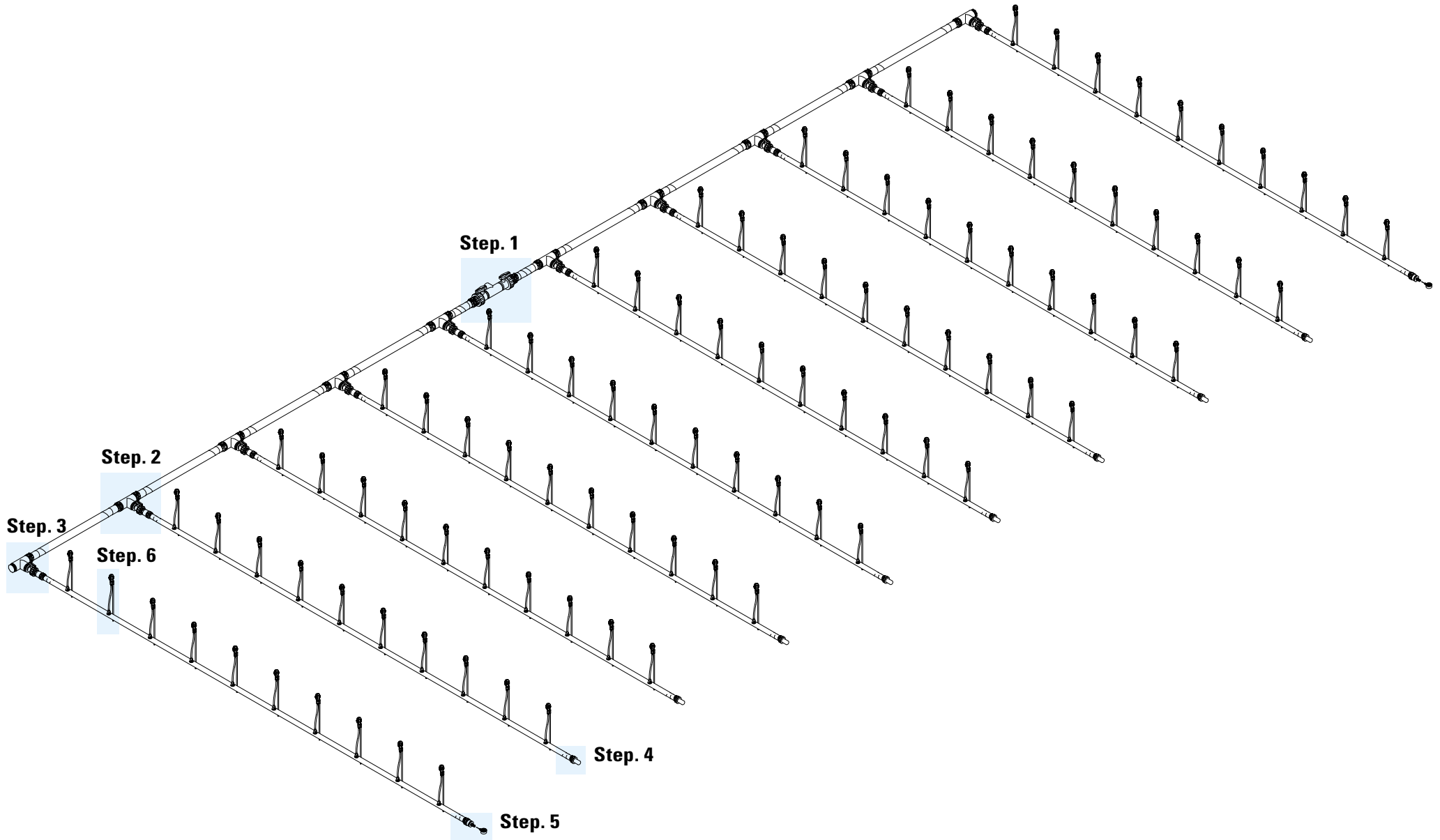

Assembly step 1 - All systems

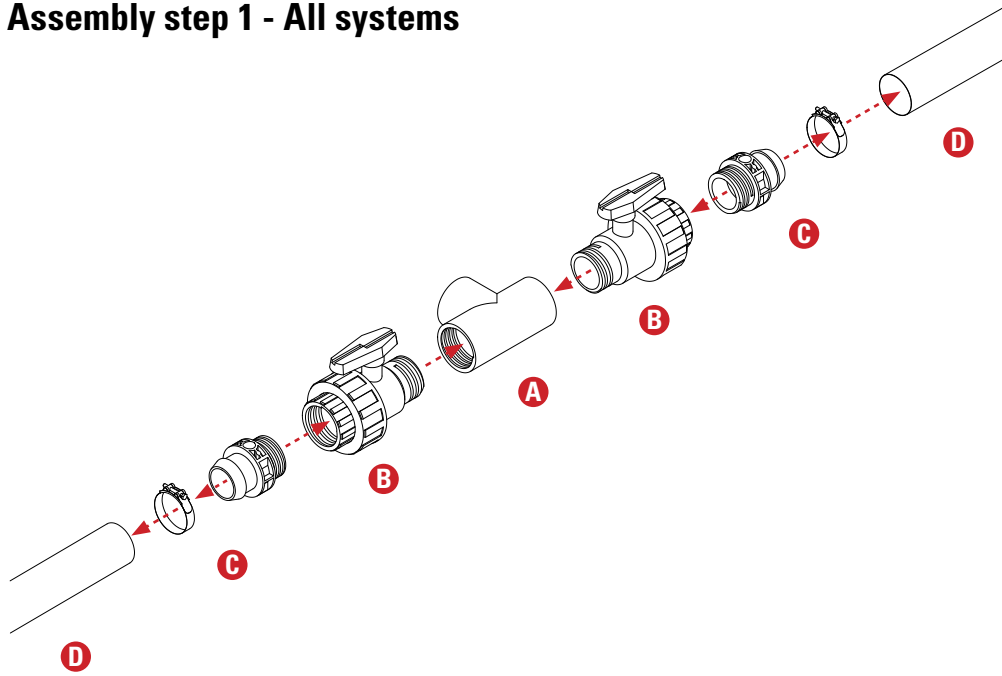

Assembly step 2 - systems A and B

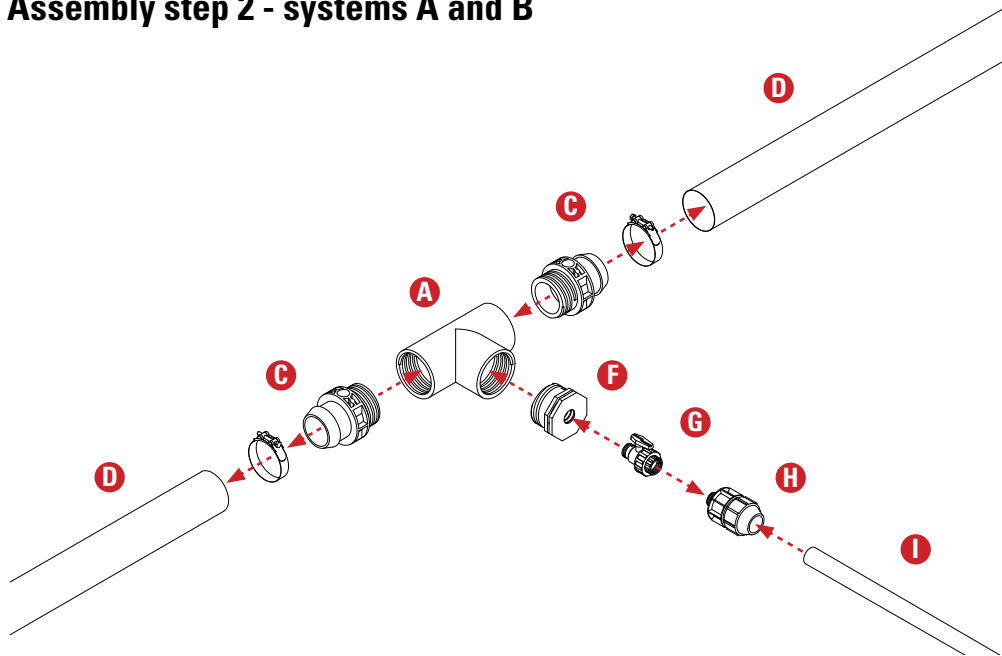

Assembly step 3 - systems A and B

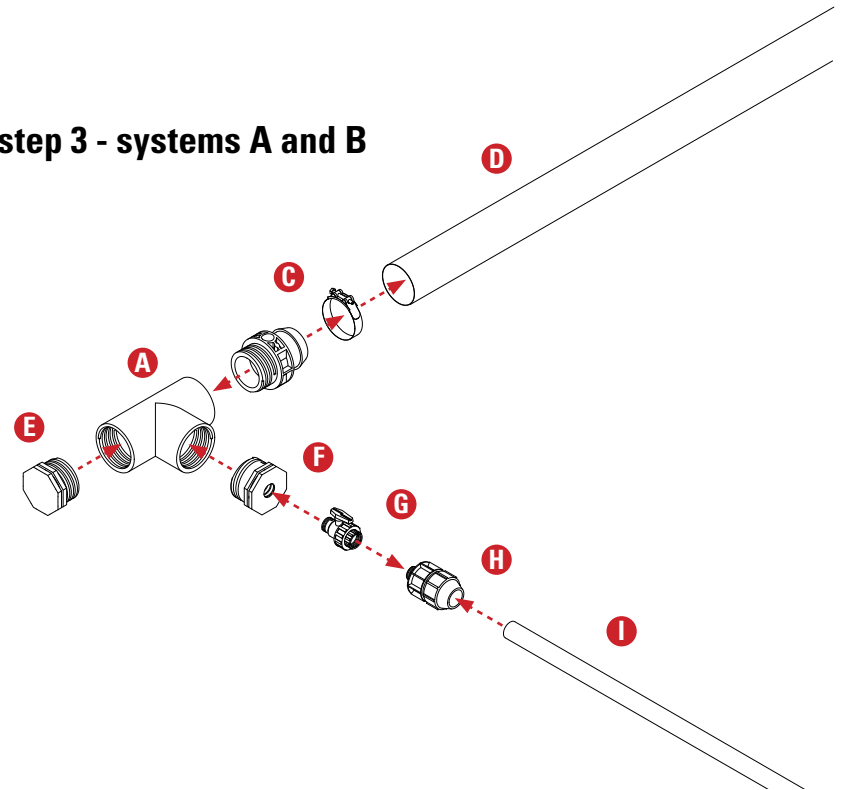

Assembly step 2 - systems C and D

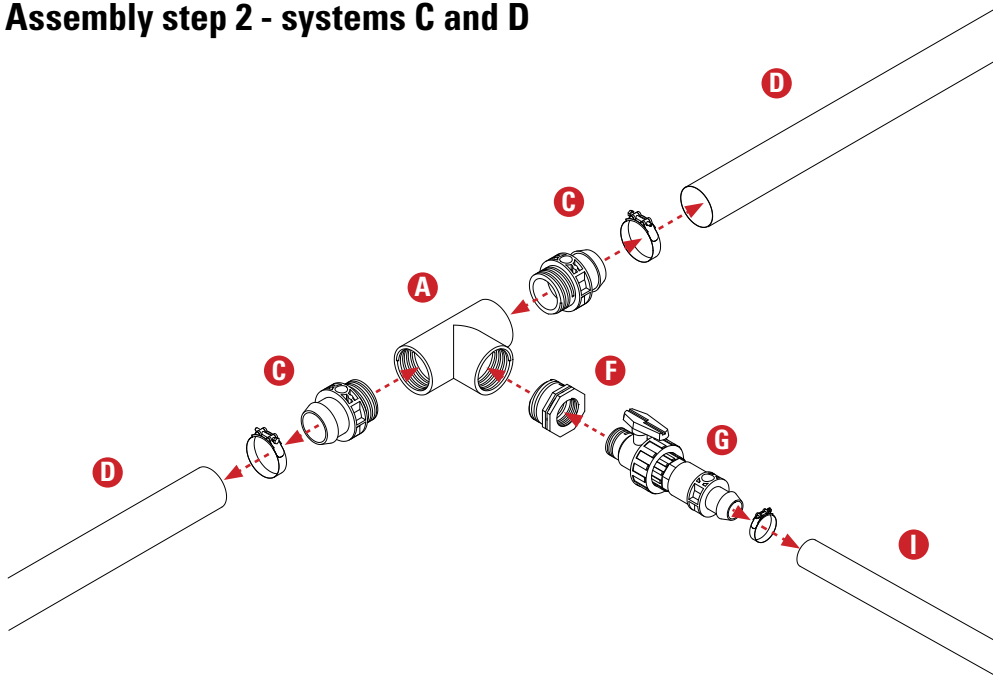

Assembly step 3 - systems C and D

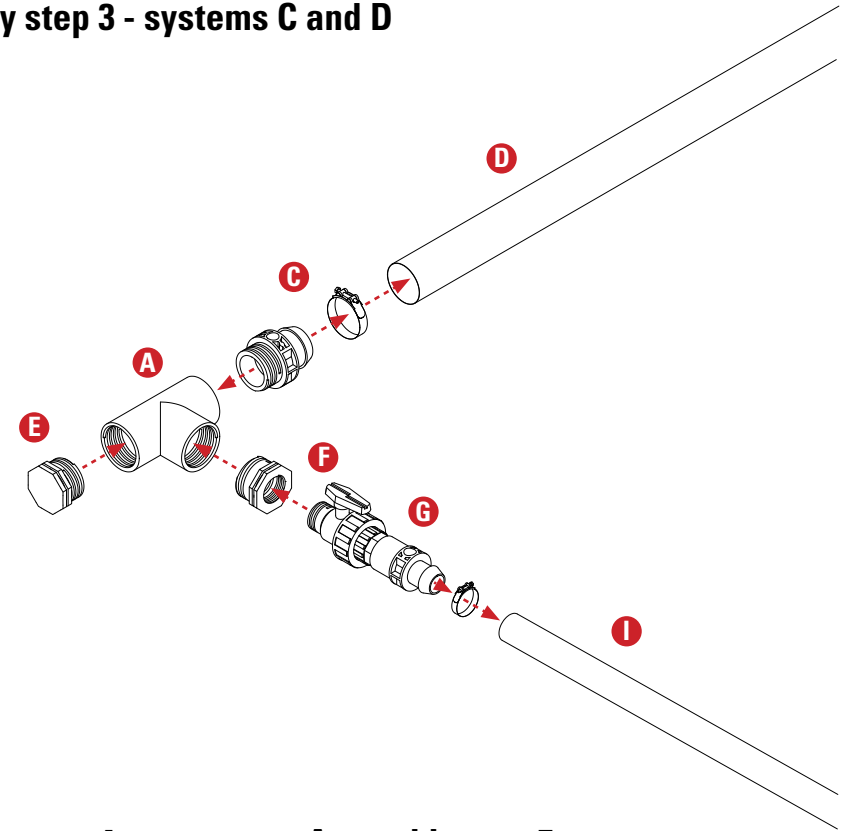

Assembly step 4 - systems A and B

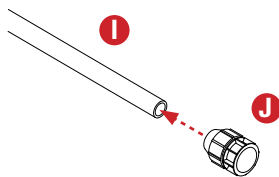

Assembly step 5 - systems A and B

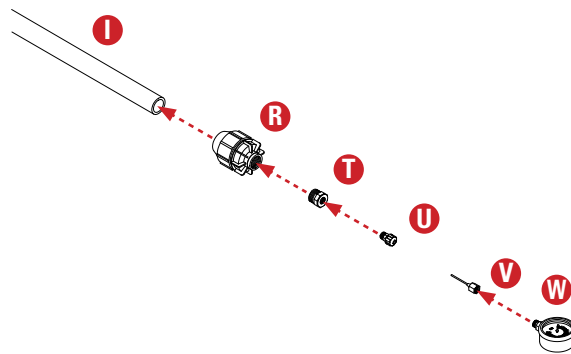

Assembly step 4 - systems C and D

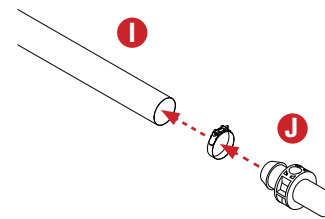

Assembly step 5 - systems C and D

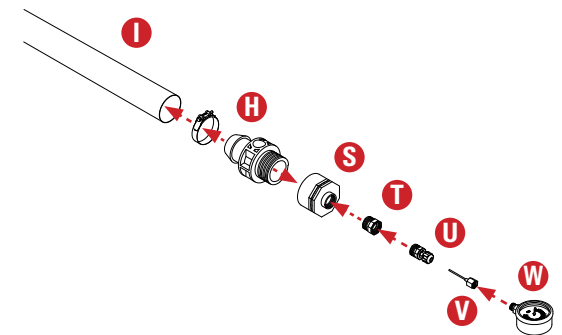

Assembly step 6 - systems A, B and D

See the IMP SPR Stand Installation Manual included in the DripK package.

Assembly step 6 - system C

See the MegaStand Installation Manual included in the DripK package.

GROW MORE WITH LESS

WWW.NETAFIM.COM